

# SMART MINIBAR

QUICKSTART GUIDE



## WELCOME

As a center table, Centracool will surely elevate your home decor to another dimension – it's all about the smallest details. A classic shape with eyes on the future is how we describe Centracool and, as you can see, this is the kind of coffee table that's bound to be the main focus in any living room. Simplicity never fails.





## ABOUT US

We at Centracool focus on intelligent home furniture solutions that multiply space. As a luxury furniture brand and due to its sophisticated technologies and perfect handicraft, Centracool has become the leader in the field of intelligent home furniture.







## GETTING STARTED

**IMPORTANT SAFEGUARDS: PLEASE READ AND SAVE THIS INSTRUCTION MANUAL**

When using electrical appliances, basic safety precautions should be followed, including:

- Read all instructions.
- Make sure the appliance is cleaned thoroughly before using.
- Do not use appliance for other than its intended use. For household use only. Do not use outdoors.
- CAUTION: flammable refrigerant used! When handling, moving, and using the refrigerator; make sure to avoid either damaging the refrigerant tubing which may increase the risk of a leak.
- Remove all bags and packaging from appliance before use.
- Cenrtacool shall not accept liability for damages caused by improper use of the appliance.
- The safety and operating instructions should be retained for future reference.
- Heed all warnings. All warnings on this product and in the operating instruction manual should be adhered to.
- Refrain from using attachments that are not recommended by the appliance manufacturer, as this may result in fire, electric shock, or personal injury.
- Do not use the product near water and/or moisture, for example: near a bathtub, sink, in a wet basement; or near a swimming pool.
- Clean only with a slightly damp, lint-free cloth. Unplug this product from the wall outlet before cleaning. Do not block any ventilation openings. Install the appliance in accordance with the manufacturer's instructions.
- Slots and openings in the cabinet are provided for ventilation and to ensure reliable operation of the product and to protect it from overheating.
- This product should never be placed near or above a radiator or heat source. This product should not be placed in a built-in installation such as a bookcase or rack unless proper ventilation is provided or the manufacturer's instructions have been adhered to.

- The provided power supply cord should be arranged so that it will not drape over the countertop or tabletop where it can be pulled on by children or tripped over unintentionally.
- Do not operate this appliance with a damaged cord, damaged plug, after the appliance malfunctions, is dropped, or damaged in any manner.
- Always unplug the appliance when not in use for an extended period of time.
- The product should be operated only from the type of power source indicated on the marking label.
- Do not overload wall outlets and extension cords as this can result in the risk of fire or electric shock.
- Object and liquid entry -Never push objects of any kind into the product as they may touch dangerous voltage points or short out parts that could result in fire or electric shock. Never spill or spray any type of liquid on the product.

## PLACING AND INSTALLATION

Before connecting the appliance to electrical power supply, leave it stand for about 2 hours, which will reduce the possibility of malfunction in the cooling system due to transport handling.

Clean the appliance thoroughly, especially in the interior. In case the interior accessories are not correctly placed, rearrange them as described in the manual.

### Choosing the Right Place

Place the appliance in a dry and regularly ventilated room. Do not place the appliance near a heat source (e.g. cooking appliances, radiators, water heaters or similar devices) and do not expose to direct sunlight. Avoid locations subject to vibrations and excessive dust, or moisture.

The appliance should be positioned at least 3 cm away from cooking appliances and at least 30 cm away from oil or coal fired stoves. If this is not possible, use an appropriate insulation barrier.

### Ventilation Requirements

Behind the appliance there should be a free space of at least 200cm wide and above the appliance kitchen units (cupboards) should be at least 5 cm away from the appliance in order to assure adequate ventilation.





## Installation

- Place the appliance firmly on a solid base. If you want to install caster wheels, secure its screws tightly.
- This appliance must be grounded. The power cord that is supplied with the appliance contains the appropriate grounding conductor and grounding plug. The plug must be plugged into an appropriate wall outlet that has been installed and grounded in accordance with all existing local codes and ordinances.
- The required nominal voltage and frequency are indicated on the rating label.
- Most people like multipurpose power outlet, it's quite convenient for home using. But it's very dangerous to share the same multipurpose power outlet for table and other home appliances. Please don't use the same power outlet for table with any other home appliances.
- Take note of the direction of the power socket under the table, and connect the power cable.
- Insert power cable plug into electrical outlet.

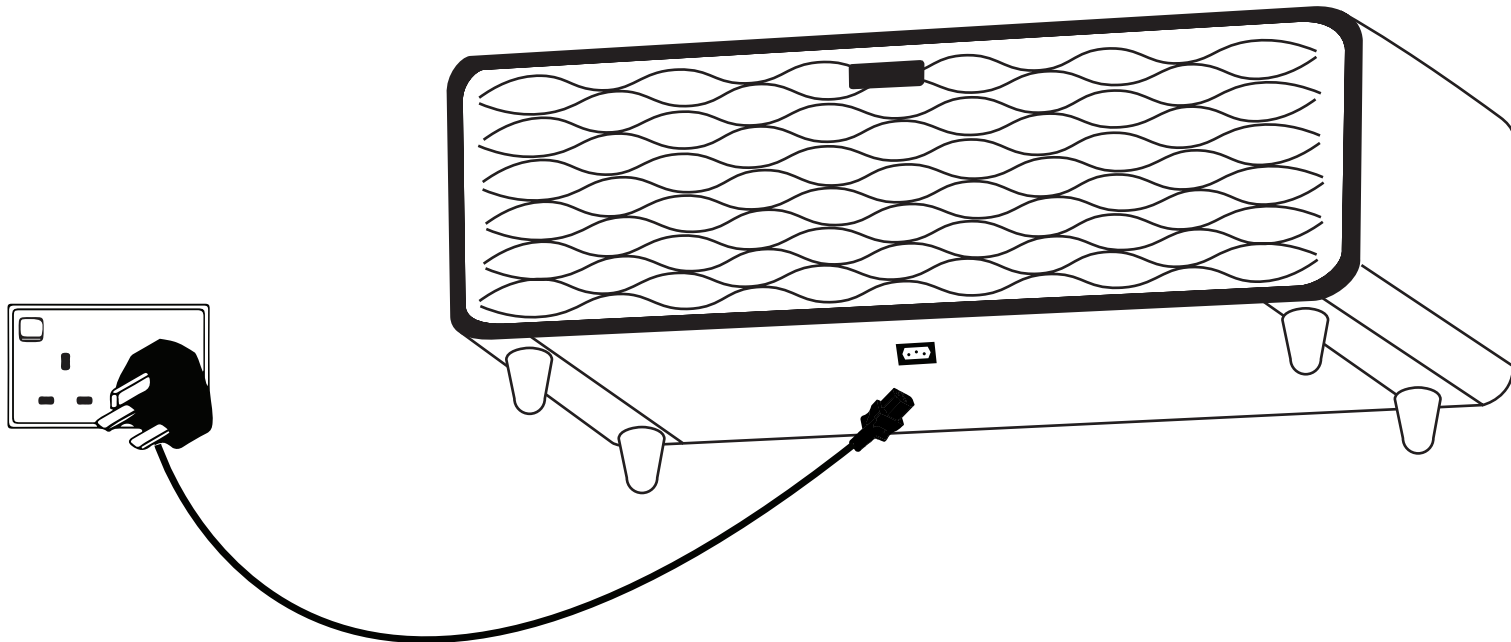

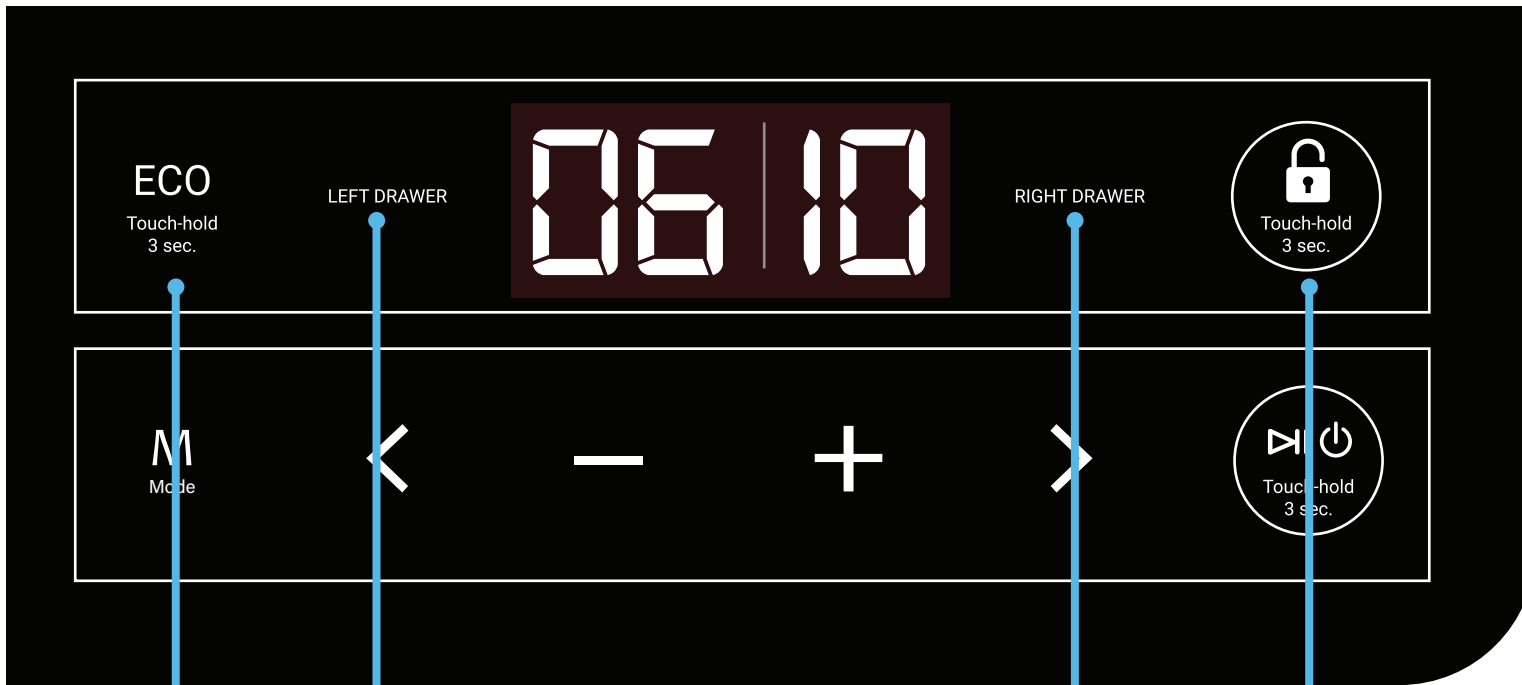

00:03

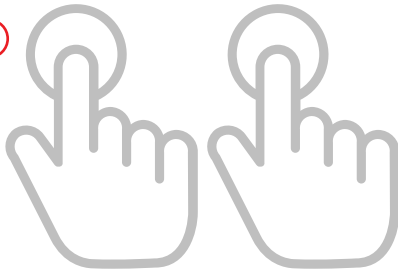

**Step 2**

Touch any of the drawers buttons. The current drawer's temperature will flash. Each time you touch, the temperature will cycle from 1 to 12 then OF (where "OF" means switching off the cooling of the selected drawer)

**Eco Mode**

Press and hold this button for 3 seconds to activate Economy or "Intelligent Power Saving" mode



If you stop pressing for more than 3 seconds, the LED display will stop flashing and the displayed temperature or mode will be applied

00:03

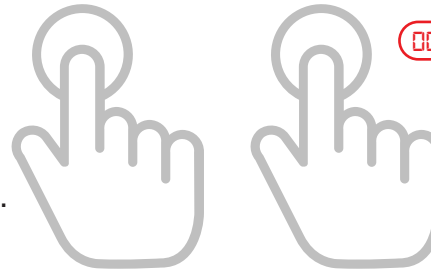

**Step 1**

Press and hold for 3 seconds to unlock the fridge temperature control

Temperature Guide

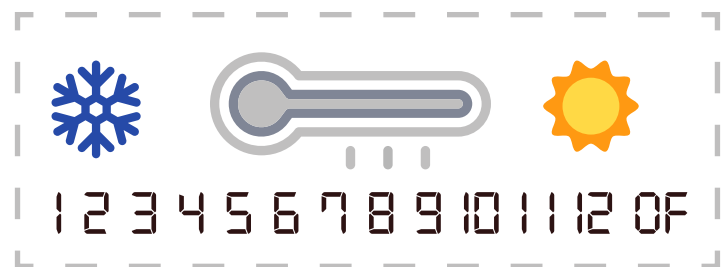

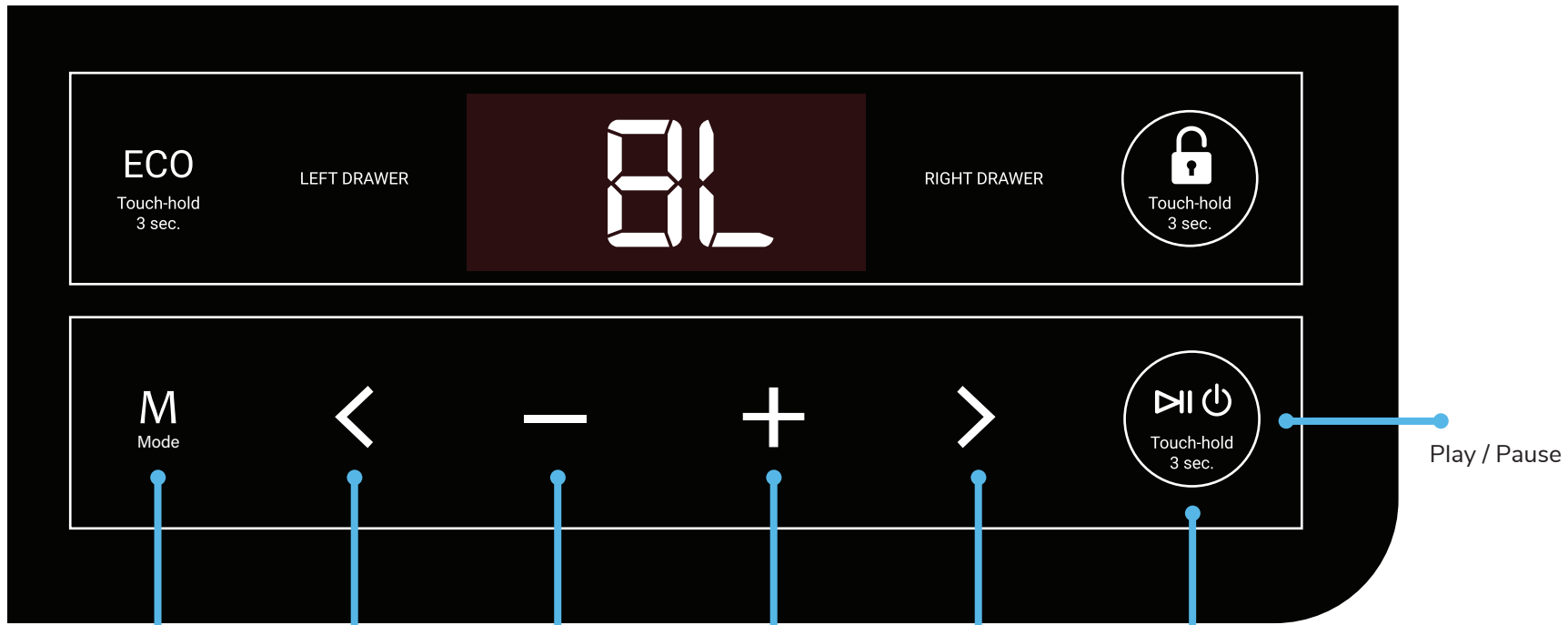

**Step 2**  
Press and release to switch between audio input modes shown below

Bluetooth



USB Flash Disk



AUX Cable



**Step 1**  
Press and hold for 3 seconds to turn on audio control



## Bluetooth

After powering on Audio control, the Bluetooth icon on the display will automatically light up. On the device you want to pair with Centracool (mobile phone, tablet, Smart TV, etc..) begin Bluetooth pairing mode. Pair with the device called “T-BAR.” When paired, the speaker will say “Bluetooth Connected”.

Specific procedures for Bluetooth pairing may vary from device to device. Check the user manual of your device for specific instructions about Bluetooth pairing. In some cases, you may need to enter a password on your mobile device to pair.

If so, type in the password 0000.

Only one Bluetooth-enabled device can be paired with the Centracool at a time. To connect a new Bluetooth-enabled device, unpair the first one, or press and hold the “Audio Power” button to disconnect.

When the bluetooth data transmission disconnected, the speaker says “Bluetooth Disconnected”. After 5 minutes, the bluetooth connection will be reset. When a previous device appears in range, the bluetooth will be automatically connected.

*NOTE: Please keep the pairing range within 10 meters.*

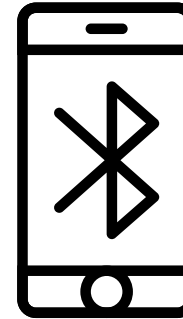

### Using Auxiliary Cable



- To use AUX cable as your audio source:
1. Select LINE or “External Audio” mode.
  2. Insert a 3.5mm audio cable into the AUX port.
  3. Control the music playing by your device.

Note: In this mode, audio interface does not support the Previous / Next track switching

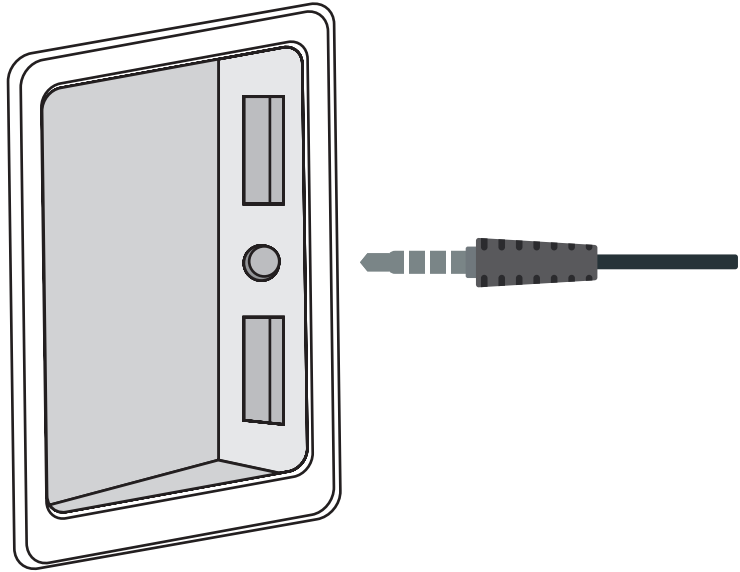

### Using USB Flash Disk



- To play music files from USB Flash Disk:
1. Select “USB Audio” mode.
  2. Insert a flash drive into the top USB port.
  3. Music files formats (MP3, WMA, APE, FLAC,WAV) will be read and played.
  4. When USB is pulled out, the voice broadcast “USB disconnected”.

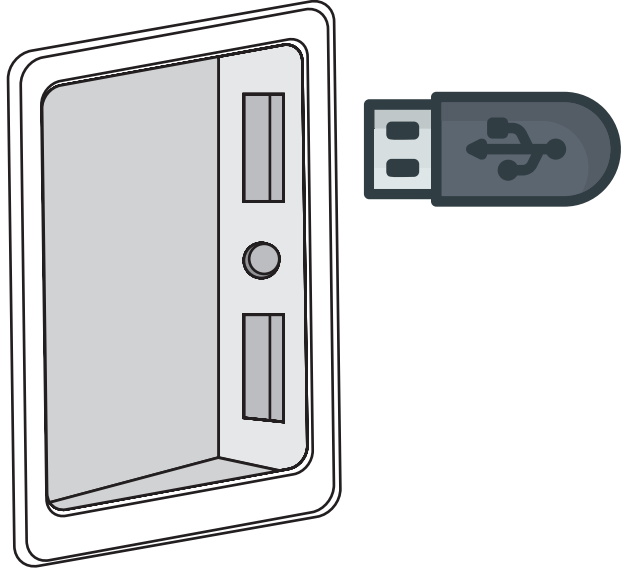

## Using the Charging Function

- Centracool is supplied with two USB ports
- Both ports can be used to charge your devices
- The upper USB port has more power, hence it is suitable for tablets
- The upper USB port can be also used to read music from a flash disk
- Once centracool table is powered on, the USB ports can be used directly

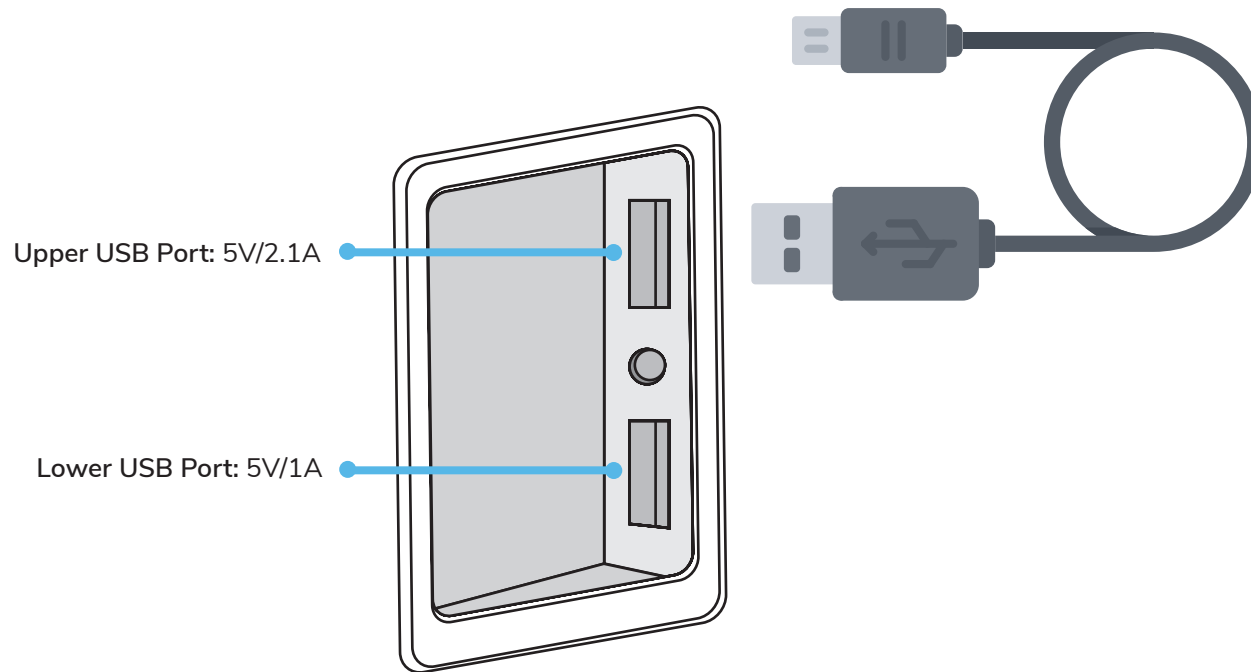



## **Cleaning & Maintenance**

- Clean Centracool table regularly to avoid the accumulation of dust. Wipe the surface of the table with the glass microfiber cloth.
- Use a small hand-held vacuum or a soft brush to clean any dust. Do not use abrasive or sharp tools to clean your Centracool.
- If you are powering off the table for an extended period of time, clean and dry the Cooler Drawer and store the Centracool in a clean, dry location. Do not place any parts outdoors.
- Before cleaning Centracool, please make sure to turn off the table and remove the plug. Do not submerge or douse any part of the appliance with water or any other liquid. Do not use abrasive or corrosive cleaning agents to clean the Centracool.

### **How To Prevent Odor Build-up:**

- Foods that may expire easily should not be placed in the Cooler Drawer. Only store non-perishable items in the Cooler Drawer. Store foods in sealed plastic bags.
- Keep the Cooler Drawer clean and dry. Clean the drawer on a regular basis

### **How To Remove Odors:**

- If your Cooler Drawers begin to develop an odor, clean the Cooler Drawers with a non-corrosive or non-abrasive cleaning agent. Dry the Cooler Drawers with a soft cloth and shut the drawers for 24 hours to remove the smell.



[centracool.com](http://centracool.com)

[centracool@cdc.com.kw](mailto:centracool@cdc.com.kw)

[instagram.com/centracool\\_kwt](https://www.instagram.com/centracool_kwt)

Kuwait